



Home in Place

WELCOME HOME TO LIVING MORE INDEPENDENTLY IN A HIGHLY SUPPORTED WAY.

NOVEMBER 2023

Hello

I joined several other SDA housing providers in providing information to SDA member organisation - SDA Alliance – to assist it with advocacy over concerns that a small number of NDIS participants have had their SDA eligibility and funding fall out of their NDIS plan or their eligibility level for SDA altered and funding reduced.

Stability of SDA eligibility for participants is vital. The NDIA has confirmed that there have not been any changes to the SDA Operational Guidelines or other NDIA operational guidance in relation to these issues. We continue to support SDA Alliance and others on advocating on this issue.

Hospital or aged care is no place for people with disability to reside long term, and SDA housing provides a much better option to support people to live more independently. It was a pleasure to have a team member call into hospital and meet a woman who will soon be moving into one of our new SDA homes on the NSW Central Coast.

Dinah gave her one of the Christmas hampers our team is busily preparing for some of our planned Christmas activities at our properties.

Speaking of new SDA properties, we have some amazing new properties coming online. There's an Open Day in December at a complex that will soon open in Western Sydney – complete with rooftop pool.

The details are in this newsletter.

Until next month,

Larissa Bridge

Executive Manager Specialist Services



Hospital visit and hamper for new resident

This month, Dinah paid a visit to one of the residents who will soon move into our new SDA complex of villas that are under construction in Toukley.

Jessie has been in an extended stay in hospital following a stroke and has minimal visitors. Jessie is looking forward to finally leaving and settling into her new purpose-built accommodation which is closer to her daughter and family.

When Dinah stopped in to have a chat, she took the opportunity to give Jessie a Christmas hamper. Jessie was so appreciative of the hamper and couldn't resist getting Dinah to hand over the Pringles!

We are looking forward to helping Jessie move out of hospital and into her new home very soon.

Your new SDA home? Merrylands, Sydney

Live your best life in this showcase SDA apartment complex in Sydney.

There are 20 SDA apartments, across levels 1 to 13, in The Quartz building in Gladstone Village to choose from. Each has an accessible car space.

Many of the apartment balconies have stunning skyline views. There are other terrace gardens and BBQ areas too. To top it all off, there is even an accessible roof top pool with built in hoist.

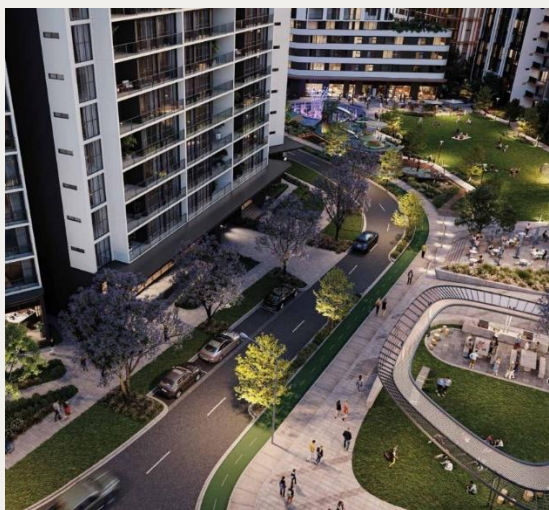

Merrylands is a connected suburb. Bus and train stations are just 130m away. At your doorstep is a supermarket, gym, restaurants and cafes. The development has 4,000 sqm of parklands to enjoy and is close to shopping and three public and private hospitals.

The apartments will be ready to move into in January 2024. There is flexible SDA funding eligibility and you can use your own support providers or the onsite Supported Independent Living (SIL) provider.

These stunning apartments won't last. Register your interest today.

[Enquire via Go Nest.](#)

Home in Place has a range of SDA properties in different SDA categories - from group homes to custom-built individual homes and apartments. We have vacancies in NSW, Queensland and Victoria. View our walkthrough videos for some properties on our [YouTube channel](#).

[View all our vacancies here.](#)

Open House Invitation – Werrington, Western Sydney

When: December 6 between 12pm and 2pm

Where: 64 Princess Street Werrington

Registrations essential: via [eventbrite](https://www.eventbrite.com)

Home in Place SDA and Supported Independent Living provider, Aruma, invite you to our open day for a new, state of the art, complex of High Physical Supports SDA homes in Western Sydney.

You will have the opportunity to view and have first pick of seven homes. Secure your unit and move in before Christmas.

There are options to live by yourself or with other people, plus flexible SDA funding eligibility. You can use your own support providers or the onsite Supported Independent Living (SIL) provider.

The easy access homes are in a quiet cul-de-sac with a park at the end of the street. Each home boasts oversized ensuite bedrooms, sunny courtyards and quality finishings, as well as easy access to transport, hospital, and shops.

OPEN HOUSE

Welcome to
Werrington

State of the art Specialist
Disability Accommodation

YOUR FIRST PICK

- OVERSIZED BEDROOMS
- SUNNY COURTYARDS
- ENSUITES
- EASY ACCESS
- FLEXIBLE FUNDING AND SUPPORT OPTIONS





See you at the Melbourne Disability Expo



We're looking forward to seeing everyone at the Melbourne Disability Expo on **November 17 and 18** at the Melbourne Convention & Exhibition Centre. You'll find us at **Booth 24**. Entry is free. Please come and say hello.

National Construction Code Classification of SDA

The Australian Building Code Board (ABCB) has withdrawn its recently issued Building Classifications for SDA advice. Developers and builders should talk to their building certifier and surveyor for advice on the correct National Construction Code (NCC) Class when developing SDA.

Meeting residents and SIL in Dubbo



Our Home4Life Program Coordinator Alex (right) and the General Manager of Home4Life Preeti visited two of the homes we manage in Dubbo. It was an opportunity to meet residents and the team from the Supported Independent Living Provider, Westhaven.

These are some of the 6-star homes built for residents who used to live in disability institutions in the Hunter region. Want to live in beautiful Dubbo? We have a vacancy in each of the homes. [Contact us](#) to find out more!

Christmas hampers are coming!

Our team has been busy preparing Christmas hampers that we'll be handing out to residents attending some of our Christmas events in NSW, Queensland, and Victoria.



Delay to SDA funding adjustments

The NDIA's Pricing Review 2022-23 Final Report outlined new SDA prices. As requested by the NDIA, we are working with our tenants and with support coordinators to double check our SDA eligible participants' information in the NDIS myplace portal accurately reflects the SDA home in which they live. This will help the NDIA with its pre work for plan adjustments.

The NDIA is implementing an automated solution to the complex task of including the new SDA pricing into as many plans as possible during October. It has notified us that for some participants' plans, the process of SDA funding adjustments will take longer than October 2023 to complete. We know this means that some owners are not getting price increases and are advocating for the adjustments to be completed as quickly as possible.

Meet the team - Nick

Nick is a new SDA Tenancy Relations Officer for the Home4Life properties in NSW that allow people formerly living in NSW Government disability institutions to live more independently in the community. He looks after property inspections and modifications and works with SILs to meet residents' needs.

He brings more than seven years' experience in providing housing support to community tenants with Home in Place.

He is relishing the new opportunity in disability housing and understanding what people with very high support needs require to live their best life.

When he is not at work, Nick enjoys spending time with his kids especially watching sport or movies. He's a keen cook, especially using his smokers. He's a basketball and rugby league fan – supporting the Sydney Kings and the St George Illawarra Dragons.

